

Selected references

Commercial and office premises

Dongfang Guoxin development, China

Client Dongfang Guoxin
Task Gloria Hotel and commercial development in Shanghai.
Size: Hotel, approx. 35,000 m² and commercial property approx. 45,000 m²
Commissioning 2008–2009



Egersund Tegl

Client Egersund Tegl a/s
Project A sustainable headquarters building in the South of Jutland for sales and marketing of the companies extensive line of products from brickyards all over Denmark
Size Approx. 1,200 m²
Commissioning 2008–2009

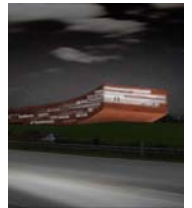

Yantai Tower Block, China

Client Aus Bio Ltd.
Task Shops, offices, hotel and housing in Yantai.
Size Total approx. 57,800 m²
Commissioning 2008–2009



Mary's – Shopping centre, etc., in Odense

Client Frederiksbjerg Ejendomme and Lillebæltsgruppen
Task New urban district on the former Danish Crown site in Odense, consisting of shopping centre, housing tower block, educational institutions and dense/low rise housing.
Size: Mall, approx. 40,000 m², housing tower approx. 15,000 m², educ. inst. approx. 18,000 m², low-dense housing, approx. 15,000 m²
Commissioning 2006–2009



Arkitema, Ørestad North

Client Arkitema and Area Ejendomme
Task New headquarters for Arkitema in Copenhagen. Besides the design studio, the building also includes housing, offices for lease and a publicly-accessible ground floor.
Size 14,000 m²
Commissioning 2006–2008



China Mobile, China

Client China Mobile, Beijing
Task Concept for showrooms
Size: Design of a large number of telecom shops in Beijing.
Commissioning 2006–2008

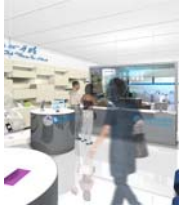

Rosengårdcentret in Odense

Client Rosengårdcentret
Project Extension of shopping centre in Odense
Size Approx. 12,000 m² con
Commissioning 2007–2008



KMD, Aarhus N

Client KPC-Byg A/S
Task Company headquarters for KMD, Erhvervspark Nord, Aarhus.
Size 5,600 m²
Year 2008



Mercuri Urval, Århus N

Client Mercuri Urval
Project New domicile to Mercuri Urval in Company Park North, Århus N
Size 1,000 m²
Commissioning 2007



Mary's – Shopping centre in Vejle

Client Frederiksbjerg Ejendomme
Project Shopping centre in Vejle – the area between the two pedestrian streets is connected with a steel construction with a glass roof. The roof encloses the existing houses, whose facades are the shopping centre's varying picture of the street life.
Size Approx. 4,000 m² new building and approx. 15,500 m² conversion
Commissioning 2007



Slotsmøllen, Kolding

Client KPC Byg A/S and Erik de Fønss
Project Slotsmøllen in the centre of Kolding with, library, hotel, industry and dwellings
Size 17,500 m²
Commissioning 2006



Selected references

B&O, the Czech Republic

Client Bang & Olufsen
Project Administration and production in Koprivnice, the Czech Republic
Size 15,000 m²
Commissioning 2006



T&O Stelectric A/S, Randers

Client T&O Stelectric A/S
Project New domicile with administration and production
Size 3,900 m²
Commissioning 2005



Fertin Pharma A/S, Vejle

Client Fertin Pharma A/S
Project Pharmaceutical chewing-gum factory, 1st stage: production facilities
 for Dandy Fertin Pharma A/S, DKK 350 million.
Size 13,000 m²
Commissioning 2004



Regional Foodstuffs Authority, Herning

Client AP Ejendoms Aktieselskab
Project Administration building for Regional Foodstuffs Authority, Herning
Size 1,900 m²
Commissioning 2004



PSG, Copper Tower, Copenhagen

Client TK Development A/S
Project New 16-storey office building for the legal firm Plesner Swan & Grønberg.
Size 13,120 m² and 1,720 m² basement
Commissioning 2004



Falck Emergency Stations in Sealand and Fyn

Client Falck and KPC-Byg A/S
Project Construction, extension and rebuilding of five Falck stations in Ballerup,
 Gladsaxe, Svendborg, Ruds Vedby and Ringsted, including garages,
 staff facilities, office, administration, stores, etc.
Size From approx. 1,000 m² to approx. 1,500 m²
Commissioning 2003 - 2004



Selected references

AON Denmark AS, Company Park Kolding

Client AON Denmark AS
Project New office building
Size Approx. 1.200 m²
Commissioning 2003



IBM and EDB-Gruppen, Aarhus N

Client KPC-Byg A/S
Project New office building for IBM and EDB-Gruppen, Erhvervspark Nord, Randersvej in Aarhus North
Size Approx. 7,500 m²
Commissioning 2003



Arkitema, Aarhus C

Client Arkitema
Project New office building for Arkitema and 300 m² shop space for hire, Frederiksgade 32, Aarhus C.
Size 2,800 m² including 300 m² shop.
Commissioning 2002



Canon, Søborg

Client Canon
Project New domicile in Søborg
Size 5,600 m² plus 1,700 m² basement
Commissioning 2002



HK Building, Ny Tøjhusgrund, Copenhagen

Client HK-Danmark
Project New headquarters for administration, etc., for approx. 400 office workplaces
Size Approx. 14,000 m² net floorage and approx. 3,500 m² underground car park
Commissioning 2002



Kommunernes Hus, Ny Tøjhusgrund, Copenhagen

Client Local Government Denmark (LGDK)
Project New headquarters for administration offices and associated service functions.
Size Approx. 13,000 m² net floorage, plus underground car park
Commissioning 2002



Selected references

Håndværkets Hus, Islands Brygge, Copenhagen

Client Danish Federation of Small and Medium-Sized Enterprises
Project New headquarters for administration offices and associated service functions.
Size 4,940 m² net floorage
Commissioning 2002



Emergency Services Centres, Smørum Nedre and Kolding

Client Falck and KPC-Byg A/S
Project Administration block and emergency services centre for Falck in Smørum Nedre and Kolding.
Size From approx. 2,000 m² to approx. 2,500 m²
Commissioning 2002



Frisko, Aarhus

Client Skanska Jensen A/S
Project Commercial development for company domicile and underground car park.
Size 17,000 m² commercial property and 10,000 m² underground car park
Commissioning 2001 - 2003



Tuborg Nord

Client Carlsberg Ejendomme
Project Company Head Office
Construction cost Approx. DKK 165,000,000 excl. VAT
Size 15,000 m²
Commissioning 2001 - 2002



CCI Europe, domicile in Holme

Client Aarhus Stiftsbogtrykkerie
Project New domicile for IT company CCI Europe
Size Approx. 17,000 m²
Commissioning 2001



Skanska Denmark, domicile in Brabrand

Client Skanska Denmark A/S
Project New domicile in Brabrand
Size 8,000 m²
Commissioning 2001



Selected references

Carl Bro Vest, domicile in Kolding

Client Carl Bro a/s
Project New company domicile in Kolding.
Construction cost Approx. DKK 25,000,000 excl. VAT
Size 3,000 m²
Commissioning 2001



Deloitte & Touche, domicile in Kolding

Client Deloitte & Touche
Project New domicile in Kolding.
Size Approx. 3,000 m²
Commissioning 2001



Greve Shopping Centre, Greve city centre

Client TK Development
Project Extension of shopping centre
Size 3,000 m²
Commissioning 2001



America Quay, Copenhagen

Client Monberg & Thorsen and TK Development
Project Offices and commercial development
Construction cost DKK 100,000,000 excl. VAT
Size 6,400 m²
Commissioning 2001



Idémøbler, Varde

Client Finn Alexandersen
Project Building and conversion of furniture centre in Varde
Size 5,000 m² new property and 5,000 m² conversion.
Commissioning 2001



Control centre, Copenhagen Airport

Client Danish Civil Aviation Administration
Project Control centre in Copenhagen Airport, DKK 60 million.
Size 5,000 m²
Commissioning 2001



Selected references

New rehabilitation centre, Aarhus

Client Aarhus County Council
Project New rehabilitation centre, DKK 36 million.
Size 2,000 m²
Commissioning 2000



Copenhagen Airport - Landside Shopping Centre

Client Københavns Lufthavne A/S
Project Office buildings and shopping centre.
Construction cost Approx. DKK 180,000,000 excl. VAT
Size 14,000 m².
Commissioning Outline proposal prepared in 1999



Aarhus Municipal Works

Client Århus Kommunale Værker
Project Expansion/extension of administration area and canteen
Construction cost DKK 14,197,000 excl. VAT
Size 1,790 m²
Commissioning 1999



Ballerup Centre

Client Datea
Project Ballerup Centre, conversion and new property, DKK 100 million.
Size 10,000 m²
Commissioning 1999



ISO Supermarket

Client Niels Jørgen Soldbro, General Manager
Project Facade renovation and expansion of ISO Supermarket, Vermlandsgade 51, Copenhagen
Commissioning 1998



Føtex, Varde

Client Dansk Supermarked
Project Føtex shopping centre in Varde, DKK 38 million.
Commissioning 1997



Selected references

Dandy A/S, Russia

Client Dandy A/S
Project Chewing-gum factory: administration block for Dandy in Novgorod, Russia. The project received the American CMAA prize for Best International Project in 2000, DKK 300 million.
Size 12,000 m² factory – 6,000 m² office buildings – 2,000 m² power station
Commissioning 1997



Berlingske Tidende, Printers

Client Berlingske Tidende
Project Rebuilding of print shop, Avedøre Holme, DKK 60 million.
Commissioning 1997



Ballerup Station Centre

Client ATP Ejendomme A/S
Project Conversion of Ballerup Station Centre, DKK 20 million.
Size 5,000 m²
Commissioning 1997



Hørsholm Midtpunkt

Client Datea
Project Hørsholm Midtpunkt – renovation and conversion
Size 28,000 m²
Commissioning 1997



Danish Immigration Service, Copenhagen

Client Danish Immigration Service
Project Rebuilding of offices, new canteen kitchen and interpreting/access and location of computer room, Blegdamsvej, Copenhagen
Size Total 2,500 m²
Commissioning 1997



Lyngby Shopping Centre

Client Danica Ejendomme
Project Lyngby Shopping Centre – roof light in main square and Hotel Ermitage, DKK 10 million.
Size 2,000 m²
Commissioning 1997



Selected references

Horse Guard Barracks, Frederiksholms Kanal

Client Ministry of Education, Building Directorate and the Palaces and Properties Agency
Project Conversion and renovation of building for the Ministry of Education, etc. Task assigned following a closed competition.
Construction cost DKK 41,000,000 excl. moms
Size Rebuilding, total 4,250 m²
Commissioning 1996 - 1997



Østerfælled, Copenhagen

Client Byggeselskabet Østerfælled A/S
Project Restorations, conversions and new property for institutions, businesses, shops and residences on the site of the former Østerbro Barracks.
Construction cost DKK 78,000,000 excl. VAT (1st stage, 9,500 m²)
Size 60,000 m²
Commissioning 1996 (1st stage completed 1993-1994)



Herning Torv

Client Herning Municipality
Project Extension of Herning Town Hall, plus shops, offices and rented housing.
Size 6,700 m²
Commissioning 1995 - 1996



Head offices for KOE

Client Kolding Områdets Energiselskab
Project Conversions and new property for administration, warehouse, workshops, stockyard, etc., in connection with the merger of Kolding Oplands Højspændingsforsyning and Kolding Kommunes Forsyningsforvaltning.
Construction cost DKK 55,000,000 excl. VAT
Size 7,700 m²
Commissioning 1995



Kgl. Brand, Copenhagen

Client Kgl. Brand
Project Office renovations, Gl. Strand, Copenhagen
Size 1,100 m²
Commissioning 1995



Selected references

Arosgården, Aarhus

Client Højgaard & Schulz A/S
Project Shops, commercial rented properties, residences and underground car park, built alongside existing buildings, plus exterior areas.
Construction cost DKK 90,000,000 excl. VAT
Size 13,000 m²
Commissioning 1992-1993



Den Danske Bank, Centre Branch, Esbjerg

Client Den Danske Bank
Project Conversion and extension of preserved building
Size 1,700 m²
Commissioning 1993



Berlingske Tidende, Copenhagen

Client Berlingske Tidende
Project Office renovations and rebuilding of administration, etc., DKK 16 million.
Commissioning 1992-1993



Torvecentret, Silkeborg

Client A/S Bycenter, Silkeborg
Project New property and shopping centre, offices, residences, new bus station and underground car park in Silkeborg town centre, plus exterior areas.
Construction cost DKK 140,000,000 excl. VAT
Size 26,000 m²
Commissioning 1992-1993



Copenhagen Science Park Symbion

Client Copenhagen Science Park Symbion
Project Science park with laboratories, offices, etc. Total renovation, DKK 65 million.
Size 20,000 m²
Commissioning 1992



Frederiks Allé, Aarhus

Client Kommunernes Pensionsforsikring A/S
Project Shops, offices, residences and car park, plus exterior areas
Size 8,000 m²
Commissioning 1987



Selected references

Service Centre West, Brabrand

Client Den Danske Bank
Project Hi-tech administration/service centre with associated canteen,
kitchen and stores
Size 5,000 m²
Commissioning 1987



Danofø, Stilling

Client Jørgen Thimmer, Danofø A/S
Project New factory with administration block, production area and warehouse
Construction cost DKK 21,000,000 excl. VAT
Size 6,200 m²
Commissioning 1987



Hummel, Stilling

Client Hummel A/S
Task Domicile for the Hummel sports company in Stilling, with administration
block and warehouse.
Size 2,215 m²
Commissioning 1987



Peter Petersen, Silkeborg

Client Peter Petersen & Co.
Project Electronics factory, with administration block and warehouse
Construction cost DKK 6,780,000 excl. moms
Size 1,365 m²
Commissioning 1985



Selected references