

Selected references

Industrial plants

Danfoss Redan A/S

Client JHL Ejendomme
Project New administration and production building in Hinnerup for Danfoss Redan
Size Approx. 6,500 m²
Occupation 2007–2008



Vestas, Aarhus

Client Vestas Wind Systems A/S
Project New development centre with research and test facilities
Size 20,800 m²
Occupation 2006–2008



B&O, Czech Republic

Client Bang & Olufsen
Project Administration and production building in Koprivnice, Czech Republic
Size 15,000 m²
Occupation 2006



T&O Stelectric A/S, Randers

Client T&O Stelectric A/S
Project New headquarters with administration and production building
Size 3,900 m²
Occupation 2005



Danish Crown

Client Danish Crown
Project Abattoir in Horsens - Europe's largest and most modern bacon factory
Size Approx. 78,300 m²
Occupation 2004–2005



Fertin Pharma A/S, Vejle

Client Fertin Pharma A/S
Project Pharmaceutical chewing-gum factory, 1st stage – production facilities for Dandy Fertin Pharma A/S, DKK 350 million
Size 13,000 m²
Occupation 2004



Vest Taulov Parcels Centre

Client Post Danmark
Project New central parcels sorting office, designed for Post Danmark's production methods, with the accent on staff well-being
Size 15,000 m²
Occupation 2004



Falck Emergency Stations in Sealand and Fyn

Client Falck and KPC-Byg A/S
Project Construction, extension and rebuilding of five Falck stations in Ballerup, Gladsaxe, Svendborg, Ruds Vedby and Ringsted, with garage complexes, staff facilities, office, administration, stores, etc.
Size From approx. 1,000 m² to approx. 1,500 m²
Occupation 2003 - 2004



Emergency Services Centres, Smørum Nedre and Kolding

Client Falck and KPC-Byg A/S
Project Building of administration block and emergency services centre for Falck in Smørum Nedre and Kolding
Size From approx. 2,000 m² to approx. 2,500 m²
Occupation 2002



Fuglsang Maltfabrik A/S

Client Fuglsang A/S
Project New malt factory in Fredericia, master plan
Size Approx. 15,000 m² (Phase 1)
Occupation 2002

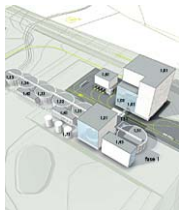

Linak, Als

Client Linak A/S
Project Electronics factory in Als
Construction cost Approx. DKK 60 million excl. VAT
Size 10,500 m²
Occupation 2002



Ingram Micro

Client Sjælsø Gruppen
Project Distribution centre with warehouse, packing and administration departments
Size 12,000 m²
Occupation 2000



Selected references

Dirol / Stimorol, Russia

Client Fertin Pharma A/S
Project Chewing-gum factory, administration and production building for Dirol/Stimorol (formerly Dandy) in Novgorod, Russia In 2000, the project received the American CMAA prize for Best International Project
Construction cost DKK 850 million
Size Administration 4,000 m², production 16,000 m²
Occupation 1999



Mobilix

Client NCC Byg A/S
Project Installation of administrative and technical facilities
Construction cost Approx. DKK 50 million excl. VAT
Size 7,300 m²
Occupation 1999



MKA 1, Århusværket

Client I/S Midtkraft
Project CHP station with equipment, boiler room and fuel silos, plus control room, staff room, etc.
Construction cost Budget: approx. DKK 1.3 billion, excl. VAT
Occupation Not yet constructed - 1st prize in architectural competition 1996



DPD Centre, Kolding

Client Transit Transport Danmark
Project Administration and package distribution centre
Construction cost DKK 4 million excl. VAT
Size 960 m²
Occupation 1996

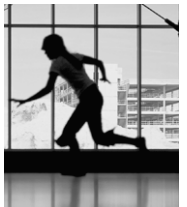

Silkeborg District Heating Plant

Client Silkeborg Kraftvarmeværk I/S
Project Machine hall, workshop, control room, personnel and administration rooms, outdoor areas
Construction cost DKK 70 million excl. VAT
Size 5,600 m²
Occupation 1995



Selected references

Head offices for KOE

Client	Kolding Områdets Energiselskab
Project	Conversions and new property for administration, warehouse and workshop facilities, stockyard, etc., in connection with the merger of KOH (Kolding Oplands Højspændingsforsyning) and KKF (Kolding Kommunes Forsyningsforvaltning).
Construction cost	DKK 55 million excl. VAT
Size	7,700 m ²
Occupation	1995



DSB Unit Goods Terminal in Taulov

Client	DSB Gods, J&B Byggeproduktion A/S, JME Kolding
Project	Platforms, sorting hall, personnel facilities, administration and outdoor areas
Construction cost	DKK 50 million excl. VAT
Size	16,000 m ²
Occupation	1994



Kolding District Heating Plant

Client	Kolding Kommunes Forsyningsforvaltning
Project	Extension and rebuilding of incinerator hall, silo, turbine and condensator building, workshop areas and personnel facilities, plus representation rooms
Construction cost	DKK 12 million excl. VAT
Size	2,000 m ²
Occupation	1993



Danofø, Stilling

Client	Jørgen Thimmer, Danofø A/S
Project	New factory with administration block, production area and warehouse
Construction cost	DKK 21 million excl. VAT
Size	6,200 m ²
Occupation	1987



Hummel, Stilling

Client	Hummel A/S
Task	Domicile for the Hummel sports company in Stilling, with administration building and warehouse
Construction cost	DKK 14,600,000 excl. VAT
Size	2,215 m ²
Occupation	1987



Selected references

Peter Petersen, Silkeborg

Client Peter Petersen & Co.
Project Electronics factory, including administration block and warehouse
Construction cost DKK 6,780,000 excl. moms
Size 1,365 m²
Occupation 1985



Purup Electronic, Lystrup

Client Arne Purup
Project Administration and development workshops
Size 6,000 m²
Occupation 1984 - 1985



Aarhus Municipal Works

Client Århus Kommunale Værker
Project Offices for Aarhus Municipality's water, heating and electricity supplies, plus canteen and kitchen, reception and meeting rooms for 5th dept.
Construction cost Approx. DKK 35 million excl. VAT
Size 6,000 m²
Occupation 1982 - 1983



Purup Grafiske Hus, Tranbjerg

Client Arne Purup
Project Extension of reprographic dept., rebuilding
Occupation 1976 - 1978



Selected references